



Call for art projects

**A garden dedicated to Seattle (USA) in Nantes (France)
Artistic, landscape or architectural work in the Grand Blottereau Park**

**Artists, landscape designers and architects based in the Seattle area :
this call for projects of Nantes City (Pays de la Loire, France) is for you.**

This project is part of a historic twinning between the cities of Seattle and Nantes. The program is aimed at artists, landscape architects or architects living in the Seattle area, either alone or as part of a group, inviting them to create a permanent work of art, landscape or architecture in one of Nantes City's most beautiful parks : Grand Blottereau Park.

Over the past 40 years, this park has seen the creation of a number of areas dedicated to different regions of the world or countries, including a Mediterranean rock garden, a banana plantation, a Korean garden, an American garden inspired by the bayou and a French garden.

In 2024-25, a new area will be created, incorporating native plants and vegetation used in the traditional life of the indigenous peoples of Washington State, particularly the Coast Salish people. It is in the heart of this area that the artist(s) will create an artistic, architectural or landscape work, representative of Seattle and Washington State.

This production will benefit from technical, financial and logistical support. The work of art, landscape or architecture will be produced on site, and the artist will have access to dedicated spaces and technical support from professional builders. The artist(s) will be in contact with Nantes City's gardeners and local artists' studios, and will be warmly welcomed to set up this artistic project, which will represent a bridge between Nantes and Seattle and a lasting mark on the park.

The preliminary site visit in 2024 and the production in 2025 will be financed by Nantes City and Metropolis (see details attached).

A personalized welcome and accompaniment will be organized for the visit of the artist or duo of artists to discover the area and its teeming artistic network, making Nantes City one of the European capitals of artists.

Seattle artists, don't wait any longer to get involved!

Application deadline : **January 21, 2024**

Garden visit (mandatory) : **May 2024**

Sketch rendering: **Summer 2024**

Project submission: **February 2025**

Completion of the project : **Spring 2025**

Call for art projects

A garden dedicated to Seattle (USA) in Nantes (France)

Presentation of the Nantes-Seattle twinning

Twinning since 1980, Nantes and Seattle share common values: equity, the fight against discrimination, social inclusion and civic dialogue are at the heart of their public policies.

Nantes and Seattle wish to develop projects that benefit all citizens, especially young people. With the help of local stakeholders, notably the twinning committees (the Maison des États-Unis and the Seattle-Nantes Sister City Association), the two cities have set up numerous projects, which are constantly expanding (language, school, university, cultural and civic exchanges).

In addition, there is a particular focus on "nature and gardens". In Seattle, a major renovation project in Nantes Park was officially inaugurated in April 2022. This garden features works inspired by Claude Ponti, French illustrator and author of children's literature who worked with the Botanical Garden of Nantes. Echoing this project, the City of Nantes also wishes to create a Seattle garden on its territory.

Presentation of Nantes City

Nantes is an Atlantic port city on the estuary of the Loire river, very dynamic culturally, economically and demographically.

With over 300,000 inhabitants living in the City, and 650 000 in the Nantes region, Nantes is the sixth largest metropolitan area in France. Nantes is an attractive city which experiences strong demographic growth, with two-thirds of the population aged under 40.

Nantes City supports art and culture in all their forms, and develops its activities for everyone. Culture is an inexhaustible source of encounters and freedom, contributing to the enrichment and influence of the metropolitan area. Nantes City affirms its cultural identity, both unique and plural, open to all forms of creation, thanks to a wide range of initiatives. This is the promise of a city where sensitive experience is an integral part of its identity, its transformation and symbolic of each individuals' role to contribute to what brings us together.

Positioning itself as a key player in the ecological transition and as an active partner in international climate negotiations, Nantes City was elected European Green Capital in 2013. Its aim is to encourage all citizens to contribute to sustainable development and climate action. Nantes is currently structuring major transformation projects for the metropolitan core around the Loire River. With 100 parks, 250 km of waterways and 560 km of bicycle paths, Nantes is reinventing the city in a garden.

Culture in Nantes (in French):

<https://metropole.nantes.fr/territoire-institutions/nantes/competences-municipales/culture>

Nantes Tourism Board (in English) : <https://www.levoyageanantes.fr/en/>

Presentation of the Grand Blottereau Park

Nantes' largest park offers a journey through the world's natural landscapes. In the Grand Blottereau park, we travel between America and Korea, and immerse ourselves in unique atmospheres. Its tropical greenhouses, which can be visited, are home to utilitarian plants.

From the Mediterranean to Korea by way of the American bayou, the Grand Blottereau offers a change of scenery through a series of clearly identified areas. In the east of the city, Nantes' largest park (22 hectares!) offers the promise of a journey through different continents. This new area dedicated to Seattle will evoke the city's landscapes and identity.

SITE DESCRIPTION

- The Seattle garden sketch was designed by urban agriculture students and Nantes City's Nature and Gardens Department team. It comprises various groves of fruit trees and shrubs, herbaceous plants and climbers. It is criss-crossed by paths and a stream, and includes a central, wood-lined, amphitheatre-shaped plot (see attached documents).
- The Seattle area will take the form of a nourishing forest. The thematic focus on an edible and mainly fruit garden is linked to the importance of fruit production in the Seattle area and, more broadly, in Washington State. The fruit forest concept was inspired by the Beacon hill food forest created by Seattle residents. This innovative form of permaculture will be the first of its kind in Nantes. In addition to fruit plants, the food forest will feature plants native to the Seattle area that were used in the traditional way of life by the indigenous people of Washington State, particularly the Coast Salish people.
- The Seattle garden will be located on an area currently occupied by a lawn, next to the "American bayou".

ORIENTATION ET EXPECTATIONS FOR THE PROJECT

The work of art, landscape or architecture will mark the identity and become emblematic of the Seattle area within the Grand Blottereau park.

- The aim of the work is to be visible, attractive and long-lasting. This physical landmark will contribute to the visibility and appeal of the Seattle area located in the heart of the Grand Blottereau park, at a distance from the main traffic arteries.
- The work will give this space a strong, distinctive identity. In fact, the plants and design of the garden alone are not sufficient to provide for this strong identification for the public.
- The work should be emblematic of Seattle, representative of its region and its biogeographical and cultural particularities.
- The work can incorporate a number of uses, such as furniture, shelter or signage.
- The work may consist of a single piece or be divided into several modules.
- The work can incorporate plants.
- The work can make use of the space's water circulation system.
- The work cannot be illuminated, out of respect for the site's biodiversity.
- A low-carbon footprint/sustainable approach is expected and should be taken into account in the design, production, choice of materials, maintenance and upkeep of the work.

SCHEDULE

- » Submission of applications: November - January 2024
- » Selection of candidates, on the basis of applications and with a video audition for short-listed candidates: January 2024
- » Preliminary visits: May 2024 (expenses covered for a maximum of two people)
- » Sketch rendering: Summer 2024
- » Additional research and exchanges: June 2024 - March 2025
- » Production residency and realization of the work: March - June 2025 (with a minimum of 2 months on site, expenses covered for a maximum of two people)
- » Handover of project: June 2025
- » Official inauguration: June - July 2025

SELECTION CRITERIA

- Be a professional artist, landscape designer and/or architect, living and working in the Seattle metropolitan area (King, Snohomish, Pierce, and Kitsap counties) or affiliated with a Native American tribe in western Washington, alone or as part of a group.
- Have significant work experience in public spaces and/or gardens.
- Be available for a preliminary visit (spring 2024) and during the production residency period in 2025.
- Be available to present your work in collaboration with the École des Beaux-arts de Nantes (School of Fine Arts of Nantes) and other Nantes' cultural organizations, so that the residency and production period can include events open to the public.

POSITIVE CRITERIA

Particular attention will be paid to projects inspired by Seattle's cultural diversity and the culture of the Coast Salish people.

We strongly encourage people from underrepresented communities or communities with fewer opportunities to apply.

TERMS AND CONDITIONS OF YOUR STAYS IN NANTES

» Preliminary visit - May 2024 - up to two people for 10 days.

Transport expenses covered.

Provision of accommodation for the visit of the site and of the Grand Blottereau park.

Accompaniment by a bilingual person during your stay. Meetings with Nature and Gardens' Department team, Nantes City's public servants and elected officials and local artists.

We can also provide administrative support for visa applications.

» Production residency - March to June 2025 - up to two people for 60 days.

Provision of accommodation

Provision of work space (studio/office)

Provision of production space (machine/tools)

Payment of associated expenses (transport, meals, production) and fees for the selected artist(s).

Networking and support by a bilingual person during the residency period. Meetings with local art school students and teachers and artists.

Administrative support.

PRODUCTION CONDITIONS

Support from Nature and Gardens Department team's production workshops and the site's gardening teams will be considered on the basis of the artistic project and specific technical requirements.

Artistic work will be part of the overall project management, with support from the Nature and Gardens Department's design office and park teams.

FINANCIAL CONDITIONS

» Preliminary visit - May 2024

Covering of expenses associated with the visit: international and domestic transport Seattle/Nantes, local transport, and accommodation.

Meal expenses up to €20 per day.

» Production residency - March to June 2025

Covering of expenses associated with the visit: international and domestic transport Seattle/Nantes, local transport, and accommodation.

Meal expenses up to €20 per day.

The total budget for the project is €20,000, divided as follows:

+/- €5,000 for artist fees including transfer of rights, conception of the work and supervision of production

+/- €15,000 for production: materials and services if required, safety-related studies if necessary (stability, solidity).

JURY

The artistic jury will be made up of 10 people, including professionals, representatives of Nantes City, as well as people working in the field, specializing in landscape, architecture and art.

APPLICATION FORM

Applications should be sent by form or email only (pdf of 10 MB maximum).

Applications must be written in English or French and sent in electronic format (1 single pdf document) by January 21, 2024 to the following address: **project.seattle.nantes@gmail.com**

The application file consists of :

An illustrated statement of intent (3 pages maximum); a current artistic dossier (10 pages maximum), accompanied by explanatory text and labeled visuals relating to a selection of previous works.

A curriculum vitae.

Any application that is incomplete, does not meet the above criteria, or is received after the deadline will not be considered.

Applicants will be notified by e-mail at each stage of the selection process:

Notice of receipt of application.

Notification of file validity (complete or incomplete).

Positive or negative decision at the end of the selection process.

CONTACT AND INFORMATION

For further information :

Romain Boulay / Development and Production Manager

at MilleFeuilles (Artists' studios - Production and training platform)

Mail address: **project.seattle.nantes@gmail.com**

Call for art projects

A garden dedicated to Seattle (USA) in Nantes (France)

ANNEX



*The Grand Blottereau Park
Nantes / France*

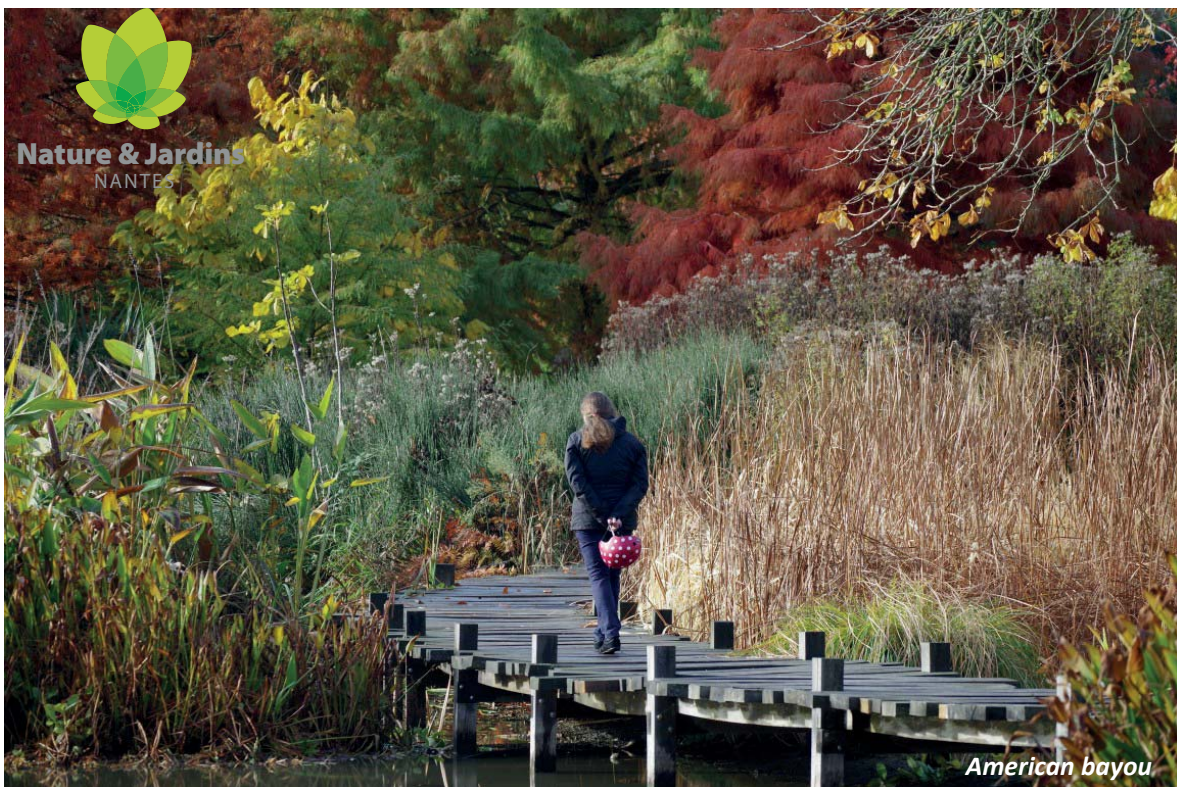

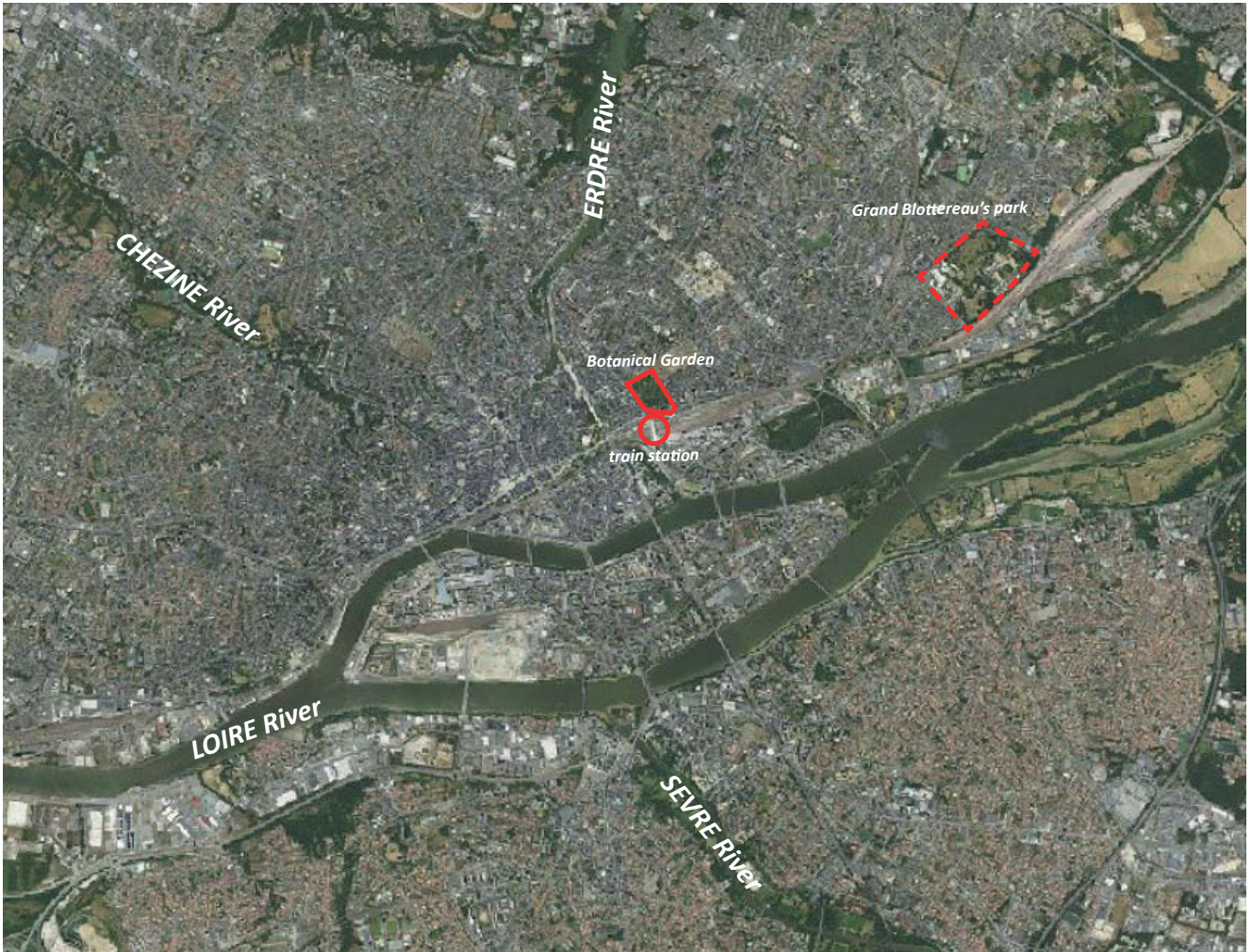

37 hectares property including 19 of parkland. Facing the 18th century castle by the architect Ceineray, this landscaped park brings together in its tropical greenhouse a unique collection of exotic plants in France. You can also see a French garden, a Mediterranean rock garden, an American Bayou and a Korean garden

For more information : <https://nature.metropole.nantes.fr/explorations-nantaises/les-11-grands-parcs>



Le parc du Grand Blottereau

Un siècle d'agronomie tropicale

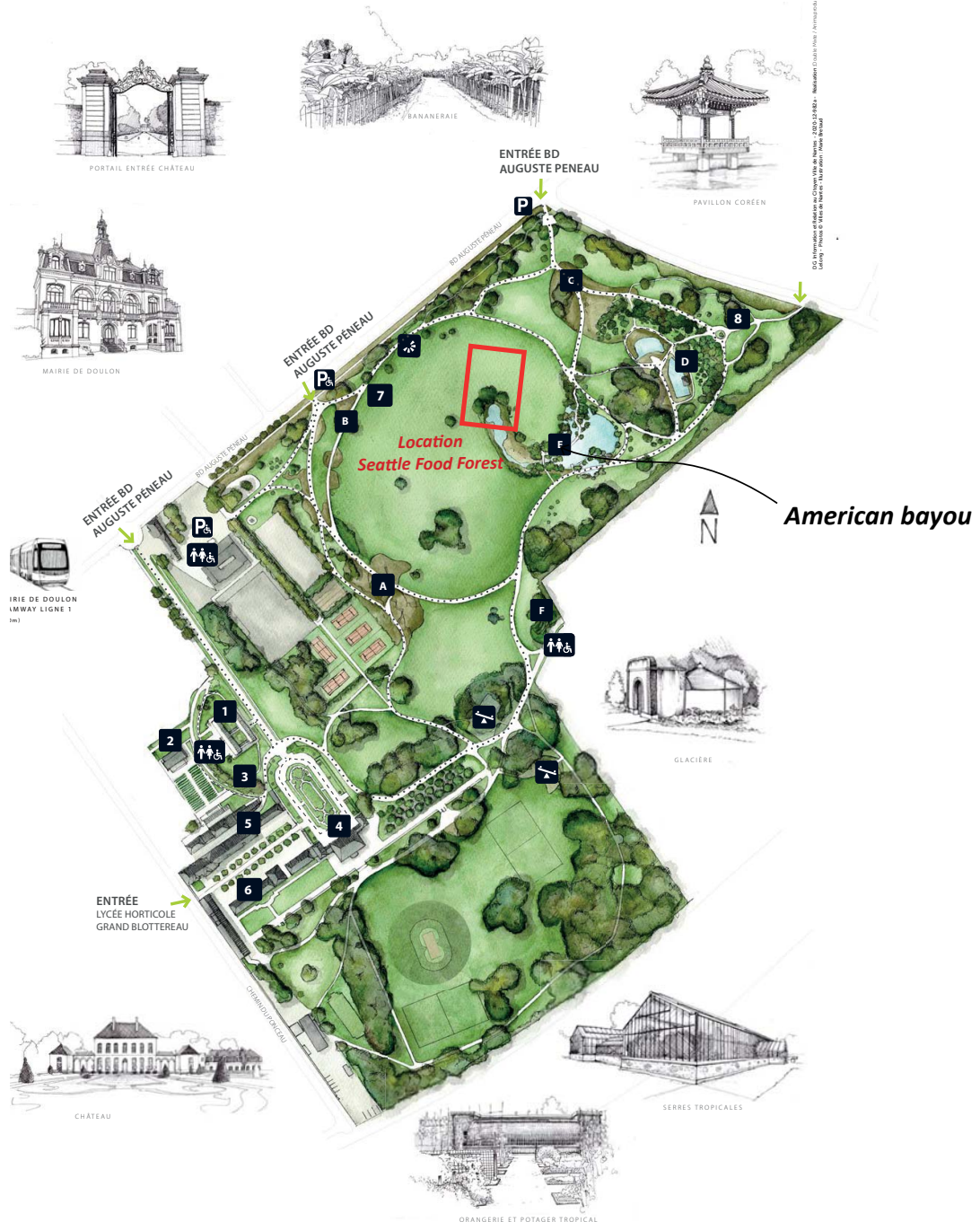

Paysages

- A. La Rocaille méditerranéenne
- B. Les tropiques
- C. La bananeraie
- D. Le jardin coréen
- E. Le bayou américain
- F. Le jardin au naturel

Patrimoine & parterres

1. Les serres tropicales
2. Orangerie, serres tempérées et potager tropical
3. Glacière
4. Château et parterre à la française
5. Services techniques
6. Lycée Horticole du Grand Blottereau
7. Pierre méditative de Lambert
8. Fontaine de Park

Accueil & loisirs

- 🏃 Aire de jeux
- 📍 Point de vue

Services

- 🚻 Toilettes
- ♿ Toilettes PMR
- ♿ Chemin accessible PMR* accompagnée
- ♿ Chemin accessible PMR*

*Accès personnes à mobilité réduite
Le parc est accessible aux personnes à mobilité réduite (suivre le parcours fléché indiqué sur le plan). La pente facilite le parcours dans le sens nord-sud, de l'entrée bd Auguste Peneau vers le château. Sanitaires adaptés.



***Project Location
map***



Food Forest

A food forest, also called a forest garden, is a diverse planting of edible plants that attempts to mimic the ecosystems and patterns found in nature. Food forests are three dimensional designs, with life extending in all directions – up, down, and out.

Beacon Hill Food Forest in Seattle for inspiration





Western Red Cedar
Thuja plicata



Douglas Fir
Pseudotsuga menziesii



Madrona
Arbutus menziesii



Red Elderberry
Sambucus racemosa arborescens



Thimbleberry
Rubus parviflorus



Salmonberry
Rubus spectabilis



Wild Ginger
Asarum caudatum



Ocean Spray
Holodiscus discolor



Ninebark
Physocarpus capitalus

***Native plants from Seattle or West
America in the project***